

PUMP SET LOADING PROCEDURE

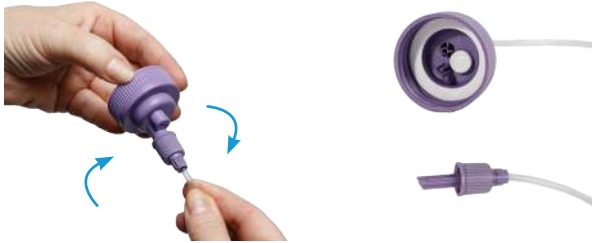

1 Choose either **SCREW** or **SPIKE** connection on 3-in-1 set and connect to feed container.



2 Close medication port before commencing feed.



3 Locate Power button on lower right-hand corner of pump. Press to turn on.



4 Confirm if you want to **KEEP** or **CLEAR** any prior pump settings.



5 Open blue door at top of pump. Grasp finger tab on valve and insert valve into valve slot on the left of pump.



6 Grasp tubing at end of black retainer (where fingers are on tubing) and gently wrap tubing anti-clockwise around rotor. Pull up retainer and insert into slot. Close blue door at top of pump.

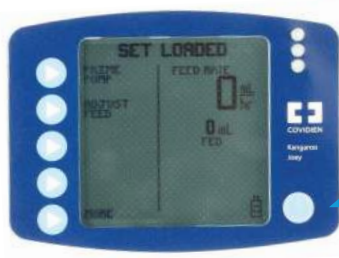

7 Display should read **SET LOADED**.

POWER DOWN PROCEDURE

Locate power button on lower right corner of control panel. Press and hold power button until the pump displays turns off.

Kangaroo™ Joey Enteral Feed and Flush Pump

USER GUIDE *(Feed and Flush Mode)*

SET PRIMING AND PUMP PROGRAMMING PROCEDURE



1

Press **PRIME PUMP** followed by **AUTO PRIME** to automatically prime or **HOLD TO PRIME** to manually prime both feed and flush lines. Press **DONE** when complete.



2

Press **ADJUST FEED** followed by **FEED RATE** to adjust hourly delivery rate.



3

Press buttons on left to program hourly feed rate. Press **ENTER** to confirm rate.



4

Press **FEED VTBD** to program feed Volume to Be Delivered (VTBD) if desired.



5

Press buttons on left to program volume of feed to be delivered. Press **ENTER** to confirm rate, followed by **DONE** to return to main screen.



6

Press **ADJUST FLUSH** to program flush volume and interval.

Press **FLUSH VOLUME** to program flush volume. Press **FLUSH INTERVAL** to program interval between each flush.



7

Press buttons on left to program volume of flush to be delivered. Press **ENTER** to confirm volume.

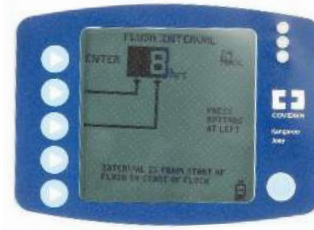

8

Press buttons on left to program flush interval. Press **ENTER** to confirm interval, followed by **DONE** to return to main screen.

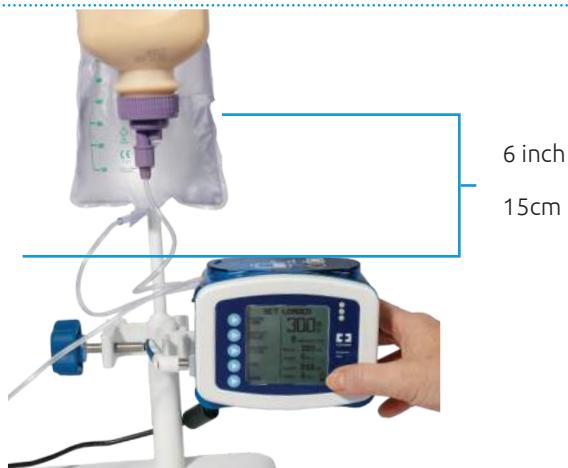

9

Press **RUN** to commence feeding regime. In order to achieve proper accuracy, the initial fluid line in the feeding set container must be 15 cm above the top of the feeding pump when initiating the feeding cycle.

GENERAL CLEANING DIRECTIONS

- (1) Disconnect pump from AC power source before cleaning.
- (2) A mild detergent should be used for general cleaning. For disinfection a 10% hypochlorite solution, isopropyl alcohol or Ammonium Chloride based solutions may be used.